



We still service equipment we built 50 years ago

The Peelle Company

373 Nesconset Hwy, #311, Hauppauge New York, 11788-2516

Tel: (631)231-6000 • 800-787-5020 • Fax: (631)231-6059 • www.peelledoors.com

November 9, 2009

TECHNICAL BULLETIN

PREVENTATIVE ACTION REQUIRED

- SUBJECT:** LANDING DOOR INTERLOCKS, LANDING DOOR LOCK AND CONTACTS AND NEMA 4/4X/7 GATE CONTACTS.
- EQUIPMENT:** PEELLE INTERLOCK/LOCK AND CONTACT PART NUMBERS 2356, 2356-59, 2356-67, 2332, 2332-32, 2332-29, 2344, 2344-32, 2344-29, 2352, 2352-52, 23526 AND PEELLE GATE CONTACT PART NUMBERS 2376, 2377 & 0320.
- DESCRIPTION:** WHEN THE CONTACT BAR USED FOR THE DC (DOOR CLOSED) CONTACT OR GC (GATE CLOSED) CONTACT HAS BEEN CHANGED OR MAINTAINED, THE WRONG SPRING OR A DAMAGED SPRING COULD BE USED IN RE-ASSEMBLY. THIS IS A POSSIBLE SAFETY CONCERN.
- ACTION:** IT IS ESSENTIAL THAT WHEN MAINTAINING THE DC/GC CONTACT, A NEW 033171 CONTACT SPRING SHOULD BE USED. PLEASE SEE SKETCH BELOW FOR PROPER SPRING SPECIFICATIONS. PLEASE CONTACT TANIA BUTLER AT (905)846-4545 x218 IF YOU REQUIRE REPLACEMENT PARTS.
- PEELLE HELP:** SHOULD YOU REQUIRE TECHNICAL ASSISTANCE, PLEASE CALL FRANK LEO AT (905) 846-4545 x230 OR STEVE MULLEN AT x215.

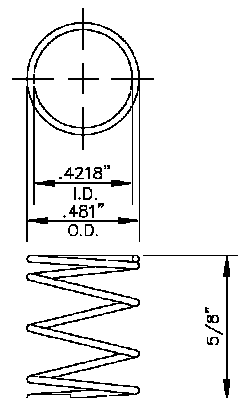
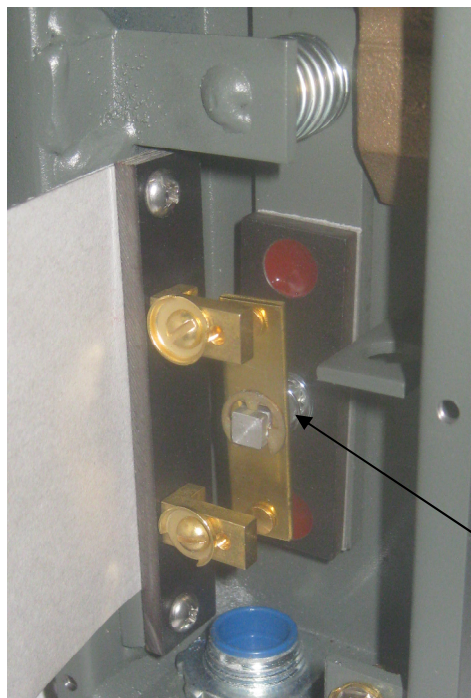

033171 CONTACT SPRING

DC CONTACT SHOWN IN INTERLOCK/LOCK AND CONTACT