

PEELLE CHANNEL ENTRANCE FRAMES

APPLICATION:

For Peelle biparting and slide-up freight elevator landing doors. Four-sided frame.

CHANNEL ENTRANCE FRAME

For masonry wall, frame includes:

- Welded Sill Assembly:
 - Structural Sill Angle (4 x 4 x 1/2 in. (100 by 100 by 13mm)) with anchors, welded to checker plate,
 - Checkerplate Sill (4-way medium pattern) welded to sill angle (sill width same as jamb width)
- Channel Steel Jamb (2 sides) (8 in. (200mm) or larger for masonry)
- Channel Steel Head-of-Frame (top member) (head width same as jamb width)
- Fire Rated ULC/UL "B" Label 1.5 hour (label furnished upon request)
- Baked Powder Coat Finish

Notes: Jamb may be larger than 8 in. (200mm) such as: 10 in. (250mm), 12 in. (310mm), etc.
 Frames are shipped either before doors or with doors.
 Frames are shipped as four separate pieces for easy handling and installation.
 Each Entrance frame requires a lintel, above the head-of-frame, by others.

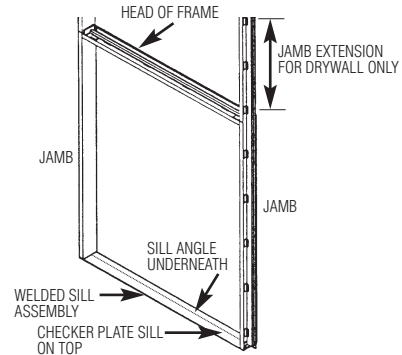

CHANNEL ENTRANCE FRAME

For drywall, frame also includes:

- Jamb-Extensions-To-Beam-Above (for strength)
- Drywall Interface Kit - mounting angles/brackets (clip angles/struts) fastened to jambs for drywall interface connection

BENEFITS:

- Welded sill assembly for strength
- Sill mounting anchors and brackets included
- Jamb mounting anchors and brackets included
- Factory color/colour to match door panels
- Easy installation
- Coordinated engineering, shipping and finish

The dimensions are for reference only and specific job requirements may alter what is shown.

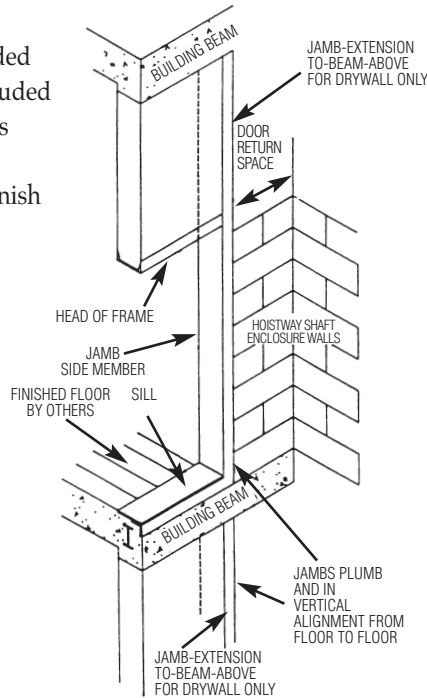

HOISTWAY SHAFT VIEW

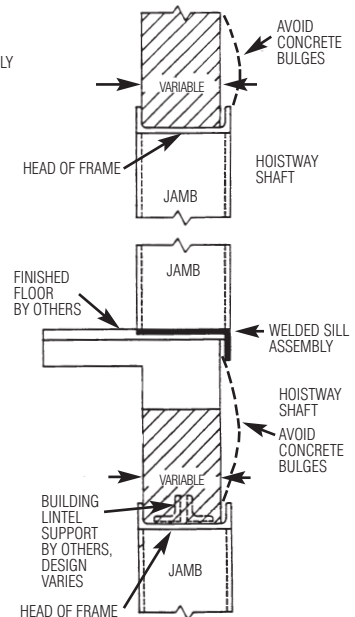

FRAME AND SILL VERTICAL CROSS SECTION THROUGH OPENING



THE PEELLE COMPANY

FREIGHT DOORS | CAR GATES | CAR ENCLOSURES
 TECHNICAL SUPPORT 1-800-787-5020 ext 275

Guide No. FAME-EN

ENTRANCE FRAME SALES SHEET

Date: May 20 / 2018

CHANNEL ENTRANCE FRAME REQUEST FOR QUOTE

The Peelle Co. Ltd.
 195 Sandalwood Pkwy. W.
 Brampton, Ontario L7A 1J6 Canada
 1-905-846-4545 • 1-800-787-5020
FAX: 1-905-846-2161
 E-mail: sales@peelledoors.com

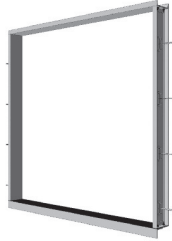

CUSTOMER DATA

Company: _____
 Address: _____

 Contact Person: _____
 Phone: _____ FAX: _____
 E-mail: _____
 Quote Needed By: _____

JOB SITE DATA

Job Name: _____
 Location: _____

 Elevator #: _____ Building: _____
 Estimated Ship Date: _____
 Old Peelle Job Number: _____

QUANTITY OF FRAMES _____

Door Openings Size: Width _____ Height _____

Floor to Floor Height _____
 B-1 1-2 2-3 3-4 4-5 5-6 6-7

Masonry Walls (block, brick, or poured concrete) Drywall (jamb-extensions-to-beam-above will be supplied)
 (no jamb extensions)

Wall Thickness _____ (minimum standard is 8 inch jamb for 8 in. (200mm) wall jamb for 7-5/8 in. wall)

UL "1.5 hr B" Labeled Frame

Frame Finish: Standard Power Coat Special Color/Colour - Powder Coat RAL # _____



THE PELLE COMPANY

FREIGHT DOORS | CAR GATES | CAR ENCLOSURES
TECHNICAL SUPPORT 1-800-787-5020 ext 275

Guide No. FAME-EN

ENTRANCE FRAME SALES SHEET

Date: May 20 / 2018